

Notes

THIS DRAWING READ IN CONJUNCTION WITH :

Key

- New Build
- Refurbished
- Vacant Space
- 1 New Treatment Centre
- 2 Paediatrics Outpatients Ward
- 3a Ward
- 4 UCC

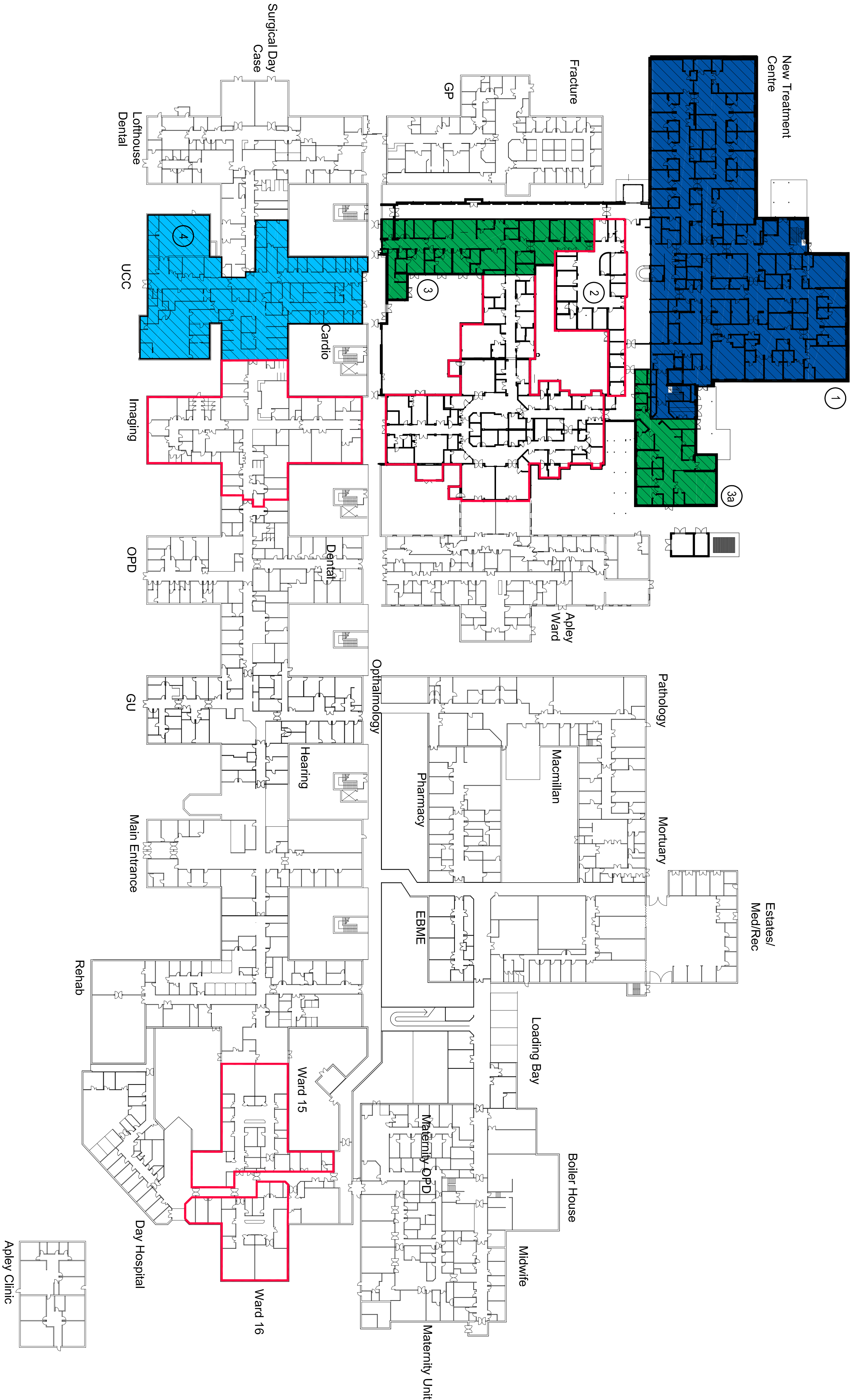

02	Updated for SOC.	08.03.16	KS	AE
01	Updated for SOC.	02.03.16	KS	AE
Rev	Description	Date	Dr by	App by
KW		15.02.16		AE

AKR Architects Ltd
AKR Architects Ltd
Victoria House
Stoke Newington
London N4 3LH
United Kingdom

T +44(0)174 329300
F +44(0)174 322717
E shrewsbury@akr-global.com
www.akr-global.com

client
Shrewsbury and Telford NHS Trust

project
Sustainable Services
Princess Royal Hospital

drawing
Proposed Potential Solution - Acute and Planned
Level 1

project number	scale	date	revision
2015_00839_001	1:500	15.02.16	02
PRH-ARR-00-ZZ-DR-A-20-121	PRH	15.02.16	SOC

This drawing is to be read in conjunction with all related drawings. All dimensions must be checked and verified on site before commencing any work or producing shop drawings. The engineer shall be notified immediately of any discrepancies. This drawing is copyright and remains the property of AKR.

Notes

THIS DRAWING READ IN CONJUNCTION WITH :

Key

- New Build
- Refurbished
- Vacated Space
- New Treatment Centre
- AEC/Empty

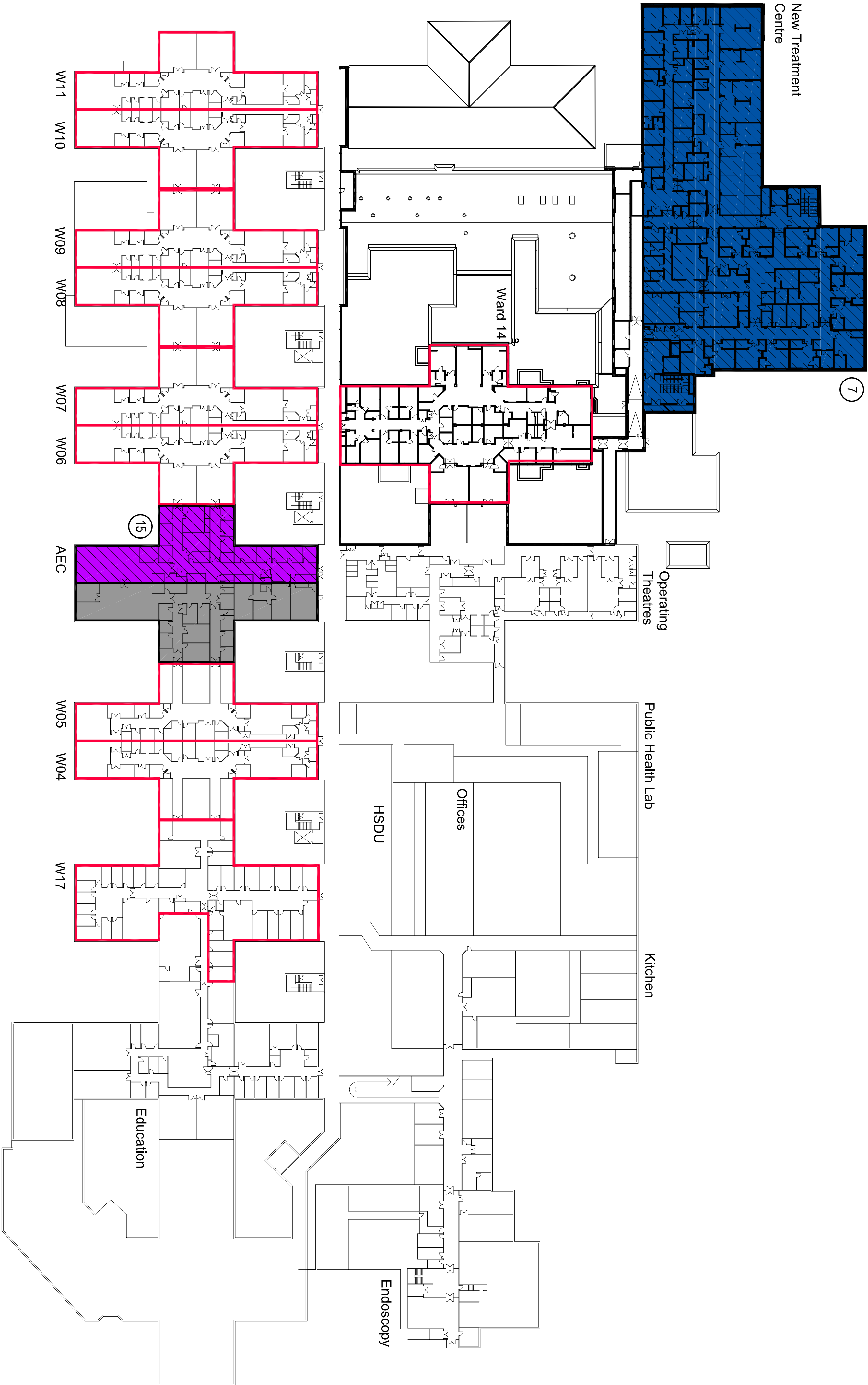

02	Updated for SOC.	08.03.16	KS	AE
01	Updated for SOC.	02.03.16	KS	AE
Rev	Description	Date	Dr by	App by
KW		15.02.16		AE

AHR Architects Ltd
150, Victoria Road
Victoria House
Stoke-on-Trent
Staffordshire
ST4 4NP
United Kingdom

T +44(0)174 328300
F +44(0)174 322717
E shrewsbury@ahr-global.com
www.ahr-global.com

client
Shrewsbury and Telford NHS Trust

project
**Sustainable Services
Princess Royal Hospital**

drawing
**Proposed Potential Solution - Acute and Planned
Level 2**

project number	2015_00839_001	scale	1:500	issue status	@A1
drawing number	PRH-AHR-00-ZZ-DR-A-20-122	rev	02	issue status	SOC

This drawing is to be read in conjunction with all related drawings. All dimensions must be checked and verified on site before commencing any work or producing shop drawings. The engineer should be notified immediately of any discrepancies. This drawing is copyright and remains the property of AHR.

Notes

THIS DRAWING READ IN CONJUNCTION WITH :

Key

- New Build
- Refurbished
- Demolished
- Estates office demolished
- Paediatrics OPD
- Womens and Children's Atrium/ Staff Admin
- MLU
- Fracture Clinic
- Office demolished
- Practice Ward
- Offices Demolished
- AEC
- UCC
- Emergency Department
- Critical Care
- Pediatrics Inpatients
- Antenatal
- Postnatal
- Circulation
- T & O Offices demolished
- Atrium/Retail/Support

02	Updated for SOC.	07.03.16	KW	AE
01	Updated for SOC.	02.03.16	KS	AE
Rev	Description	Date	Dr by	App by
KW	original by	12.02.16		AE

ARH Architects Ltd
Firm Registered
Victoria House
Strevell Way
Shrewsbury
United Kingdom

T +44(0)174 329300
E shrewsbury@arh-global.com
www.arh-global.com

client
Shrewsbury and Telford NHS Trust

project
Sustainable Services
Royal Shrewsbury Hospital

drawing
Proposed Potential Solution - Emergency & Acute
Level 0 and Level 1

project number	2015_00839_001	scale	1:750	issue status	@A1
drawing number	RSH-ARH-00-ZZ-DR-A-20-101	rev	02	issue status	SOC

This drawing is to be used in conjunction with all related drawings. All dimensions must be checked and verified on site before commencing any work or producing shop drawings. The engineer should be notified immediately of any discrepancy. This drawing is copyright and remains the property of ARH.

